

# WEST ARMSTRONG BUSINESS AND INDUSTRIAL AREA CONCEPT PLAN

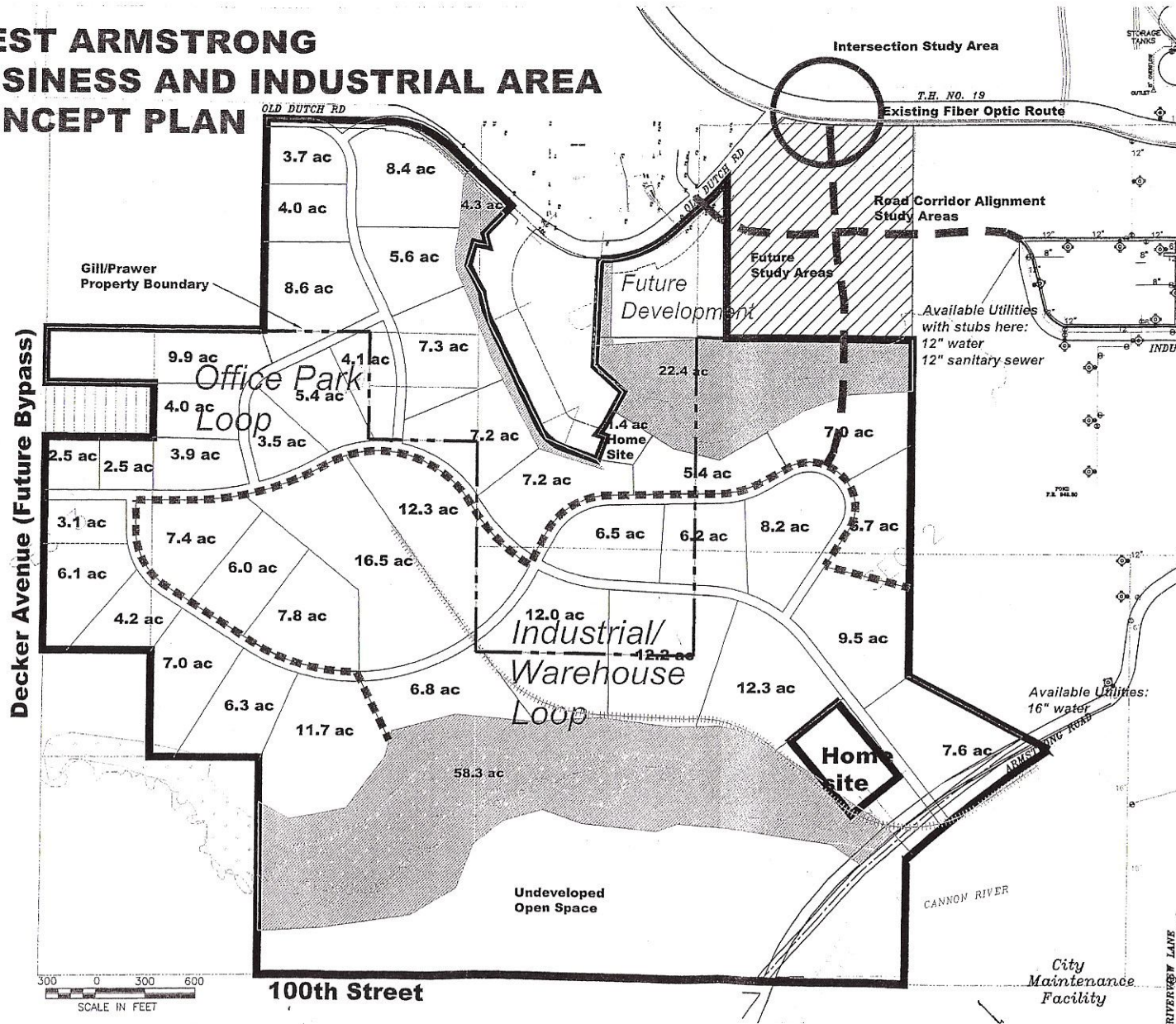

## Site Data:

### Office Park Loop:

26 lots  
 198.5 Total Acres  
 26.7 Ac. greenspace  
 12.5 Ac. rights-of-way  
 159.3 Ac. Net Devmt. Area

### Industrial Loop:

14 lots  
 276.3 Total Acres  
 58.3 Ac. greenspace  
 11.7 Ac. rights-of-way  
 206.3 Net Devmt. Area

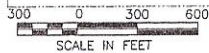

RIVERBEND LANE